

Manual No. 7422

01/26

Additional INSTALLATION

2-leaf gate or Wicket door/Leaf **CREATIV or INITIAL range**



Installation of the pivot bearings
Between-walls
or wall-mounted

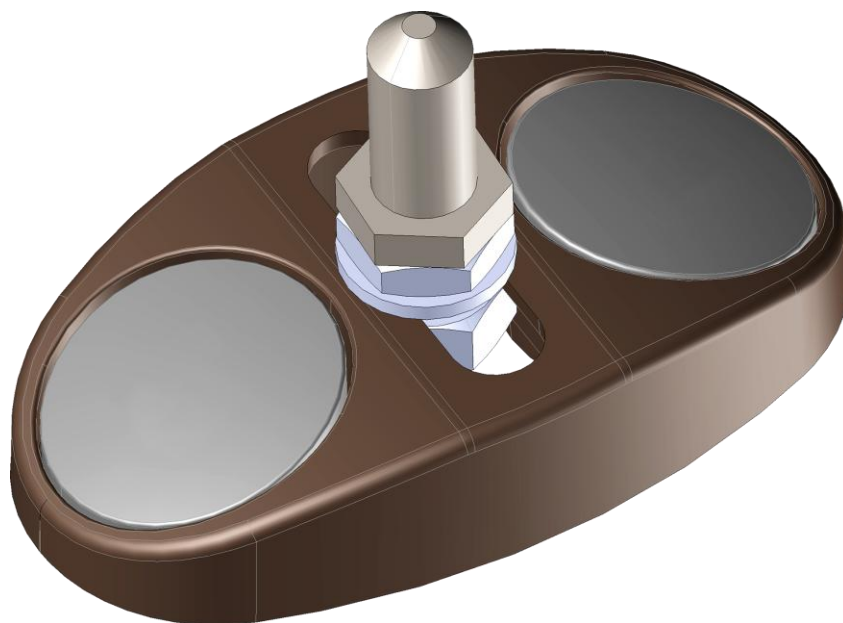

(Document reserved for installers)

Before installation

List of tools



Laser level

or

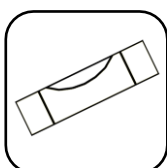

Spirit level



Plumb bob

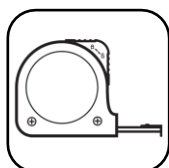

Tape measure



Pencil

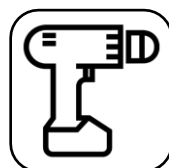

Screwdriver with bits

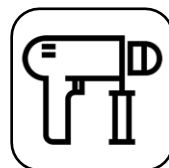

Perforator

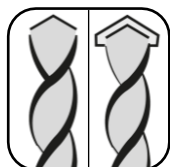

Steel/Concrete drills



Flat wrenches "extra fine"



Hammer



Hacksaw



Grinder



Mason's rule

Screws and dowels adapted to the supports.

Installation of the pivot bearings

IMPORTANT, before the installation:

Check worksite dimensions, level 0, plumb and posts alignment; detailed in the complete product installation manual.

Assembling

Between-walls: CREATIV range

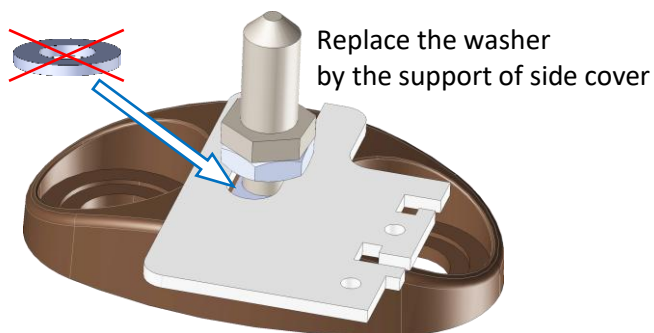

Wall-mounted: CREATIV range or Between-walls: INITIAL range

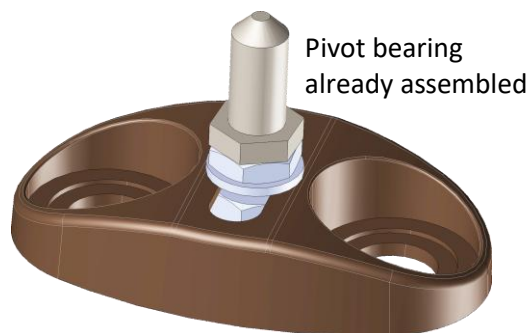

Between-walls positioning

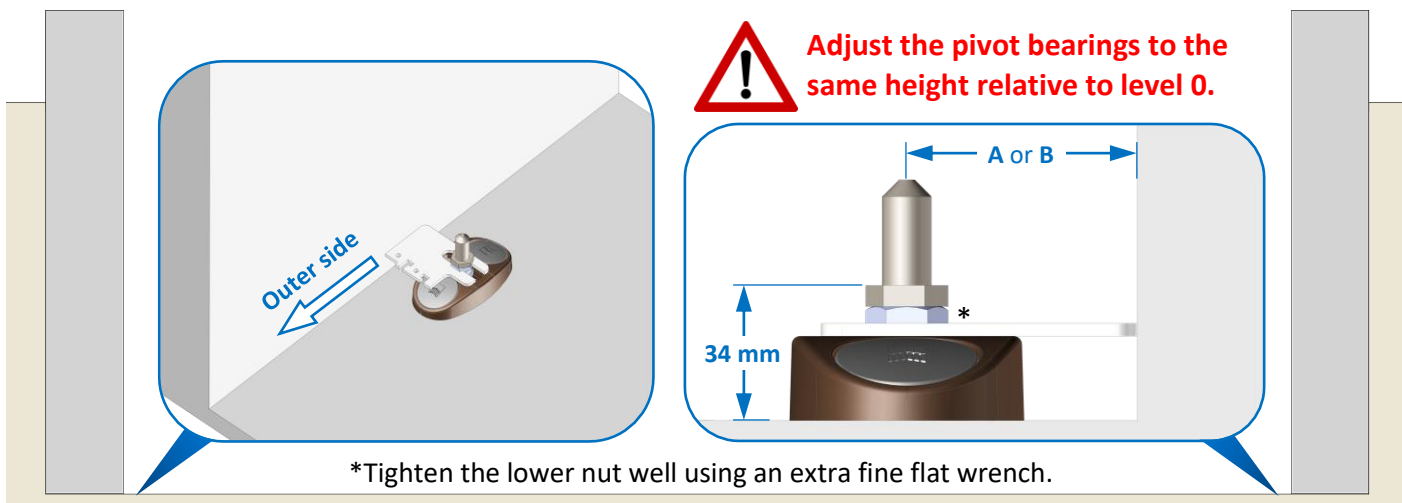

A = 55 mm in the CREATIV range

B = 60 mm in the INITIAL range

Wall-mounted positioning (only in the CREATIV range)

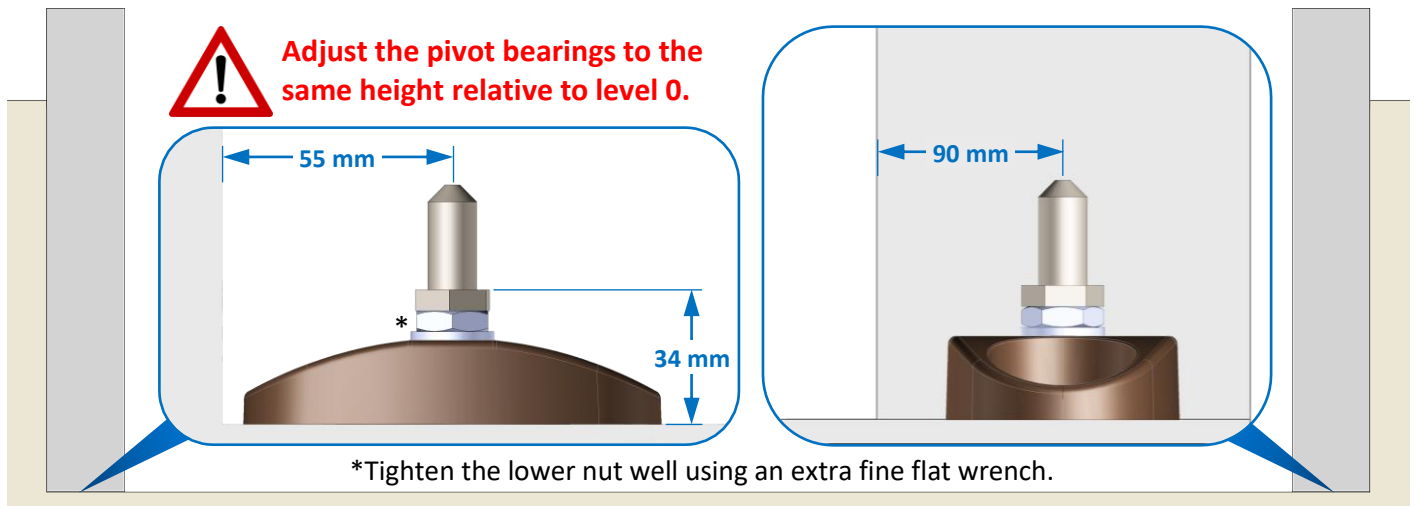

To position the 2nd pivot bearing, calculate the **Z dimension** (LP + 180 mm); refer to the complete installation manual wall-mounted, for more information.

Fixing

Drill and fix the pivot bearings to the ground, using studs or threaded rods (not supplied) adapted to the support.

Note: Recommended fasteners M8.

Add 2 eccentric adjustment washers (supplied) on each pivot bearing.

At the end of installation, after adjustments, insert the caches in their locations.

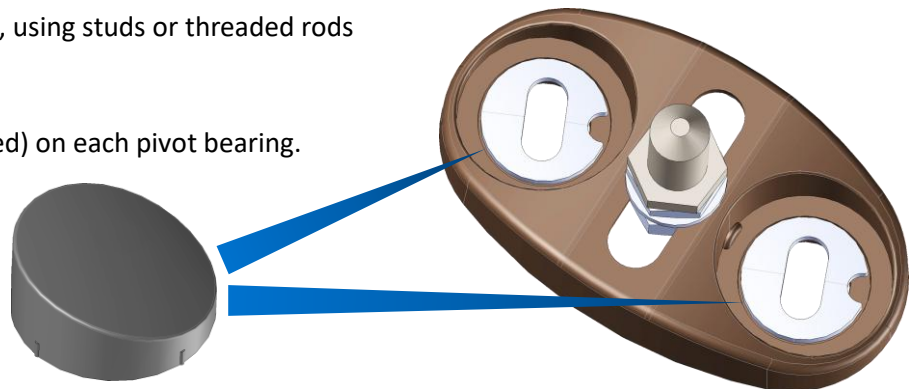

For the rest of the installation;

Refer to the complete installation instructions for the product.

Completions

Particularity: Side covers (only in the CREATIV range: Between-walls installation)

By following the complete installation instructions for the product, when assembling the side covers; it is possible to cut out the covers to bypass the pivot bearing.

