

# Manual : N° 1291

## Installation & Connection

### ***MURAX / DENTEL***

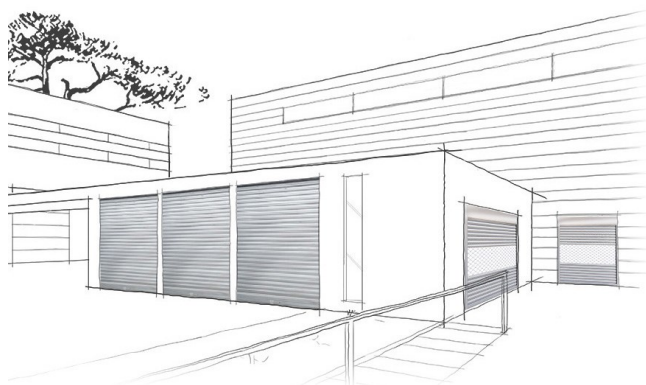

***BBA1/BBE1***  
*(wall-mounted/  
built-in button box)*



(Document reserved for installers )



- The fixed control devices must be installed within sight of the door but away from any moving parts and at a height of at least 1.5m from the floor.
- Use one switch for a single operator. It is completely prohibited to control several operators with a single monopolar switch.
- Hold to run operation, only switches necessitating a hold to run action can be installed.

## Preparation

### 1/ Unclip the bearing plate

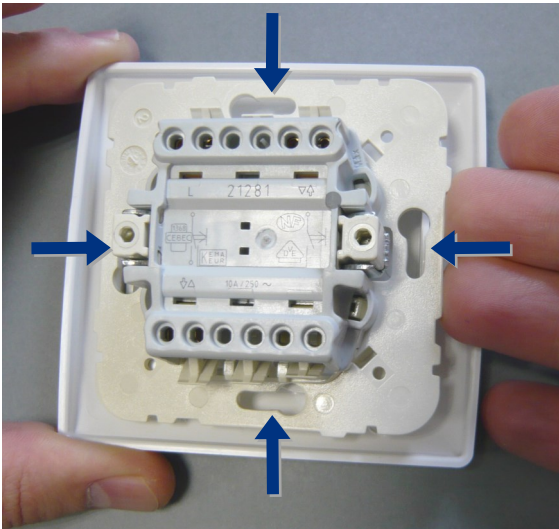

Unclip on all sides

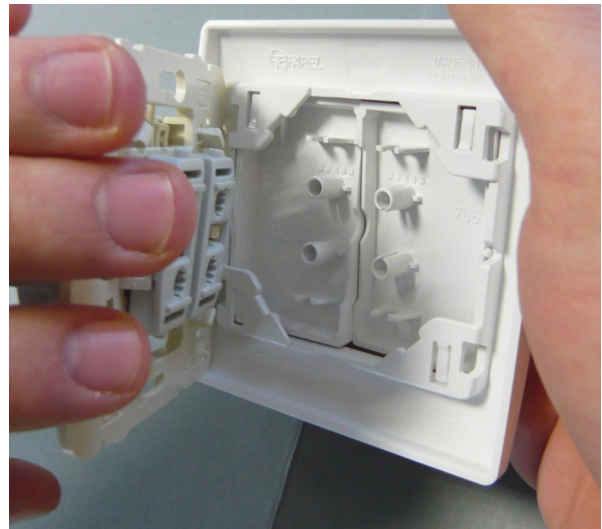

Detach the bearing plate from the plate (difficult to unclip)

### 2/ Specific point : BBA1 (wall-mounted button box)

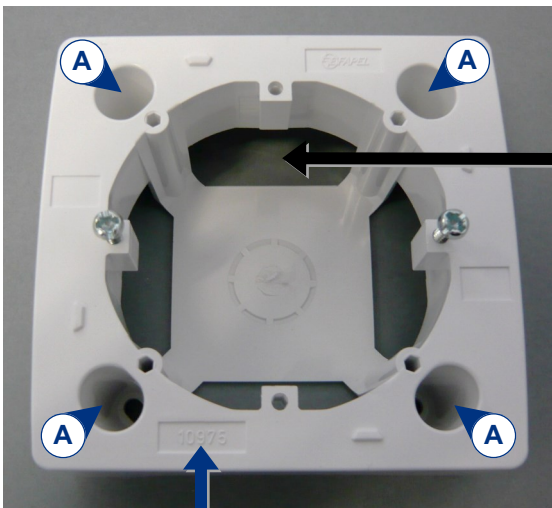

**Please note :**  
Respect the direction of the writing.

**Important :**

Before fixing the wall-mounted box to the wall, pass the electrical cables through the holes intended.

(A) Wall attachment points (screw kit not included).

# Connections

## 1/ Button box

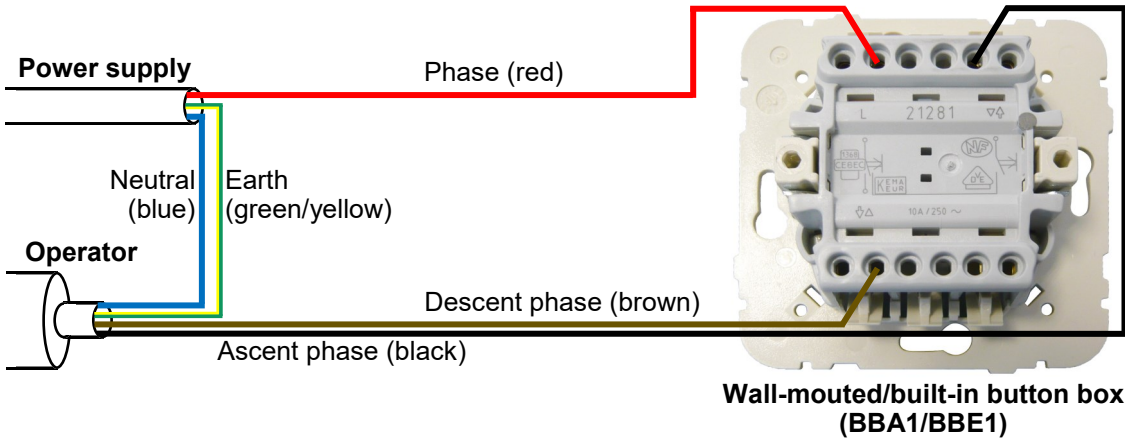

## 2/ Key switch box with button box

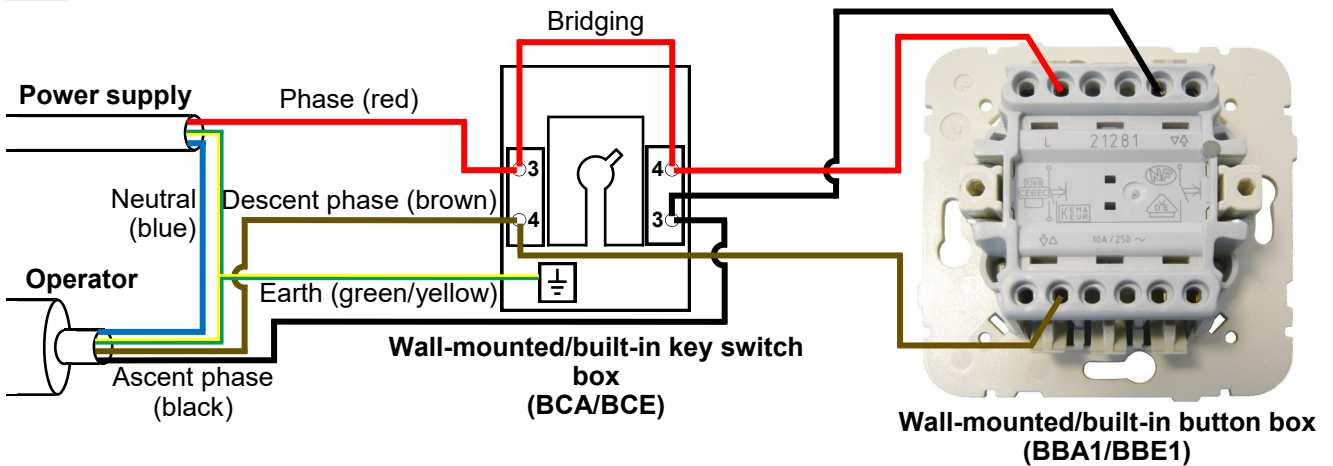

## 3/ Key switch and release box with button box

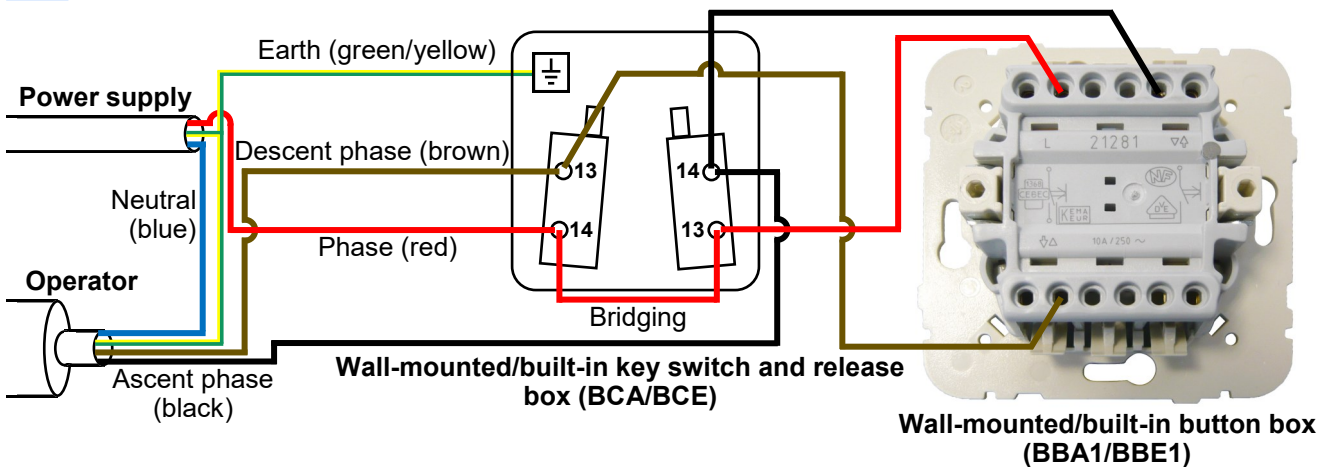

**Please note :** For the installation of the release cable, refer to the manual supplied with the housing.

**Important :**

- The cable sheath must be free (not pinched or wedged).
- The earth wire must be connected to the metal body of the key switch box using a clamp screw.
- Ensure the box is well sealed in relation to the wall support using a flexible sealant.



# Attaching the bearing plate

## 1/ BBA1 (wall-mounted button box)

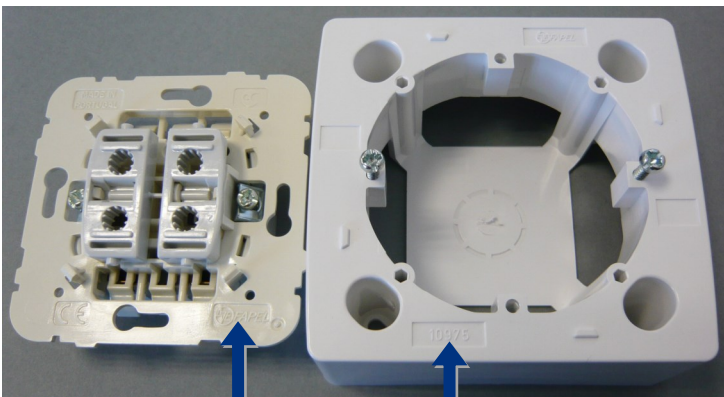

**Please note :**  
Respect the direction of the writing.

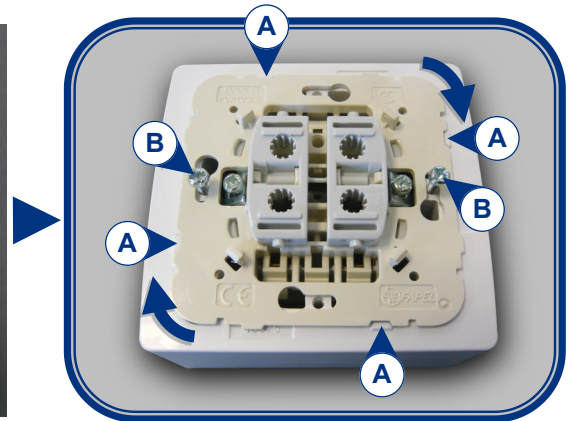

- (A) Lock the bearing plate in the notches.
- (B) Tighten the screws of the box.

## 2/ BBE1 (button box to be embed)

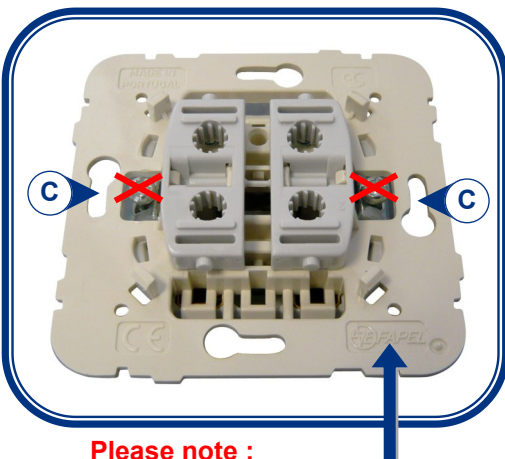

**Please note :**  
Respect the direction of the writing.

Built-in box (not included)

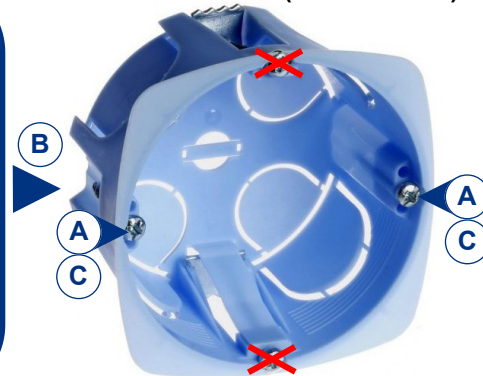

**X** Screws to remove or not to use

- (A) Loosen the screws on the built-in box
- (B) Embed the button box
- (C) Tighten the screws on the built-in box

# Finishing (BBA1 or BBE1)

## 1 / Clip on the finger plate

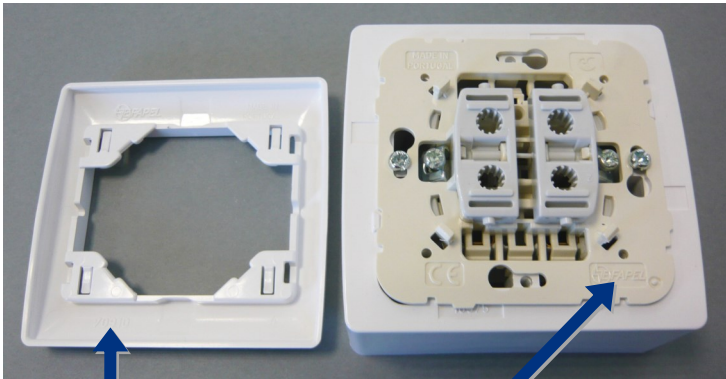

**Please note :**  
Respect the direction of the writing.

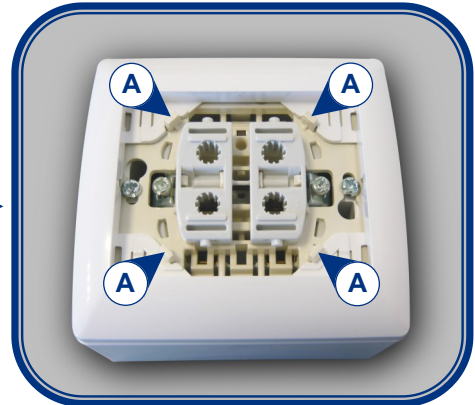

**A** Clip the plate on the lugs

## 2 / Clip on the covers

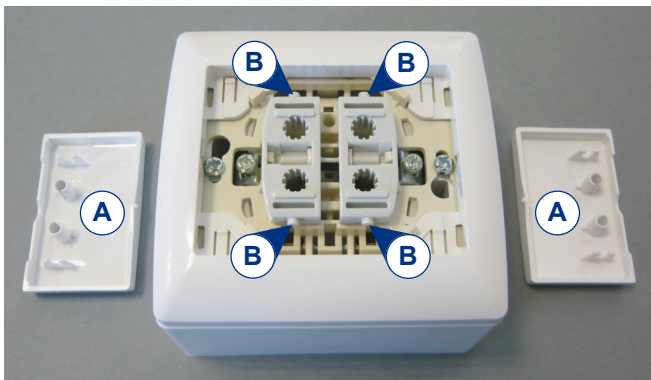

- A** Flip the covers over
- B** Clip them on the lugs



