

# Manual

## N° 7408

07/21

**OPTION** (installation complement)

## *Rear hinges*

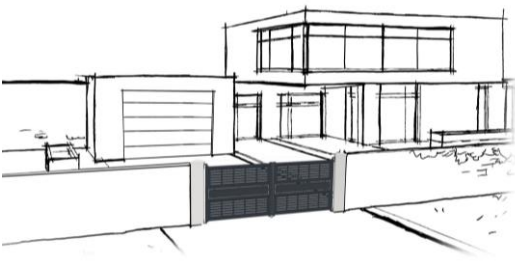

***2-leaf Gate  
or Wicket door***



(Document reserved for installers)

# Contents

Check the site dimensions .....	3
Check the 0, plumb level and post alignment .....	3
Mark out the axis to fix the strips.....	4
Inter-wall installation.....	4
Wall-mounted installation .....	4
Attach the 2 strips .....	4
Check the level between the bottom hinges .....	5
Before installing the leaves .....	5
Present and engage the leaves.....	6
Lock the leaves .....	6
Install the central stop.....	7

# Check the site dimensions

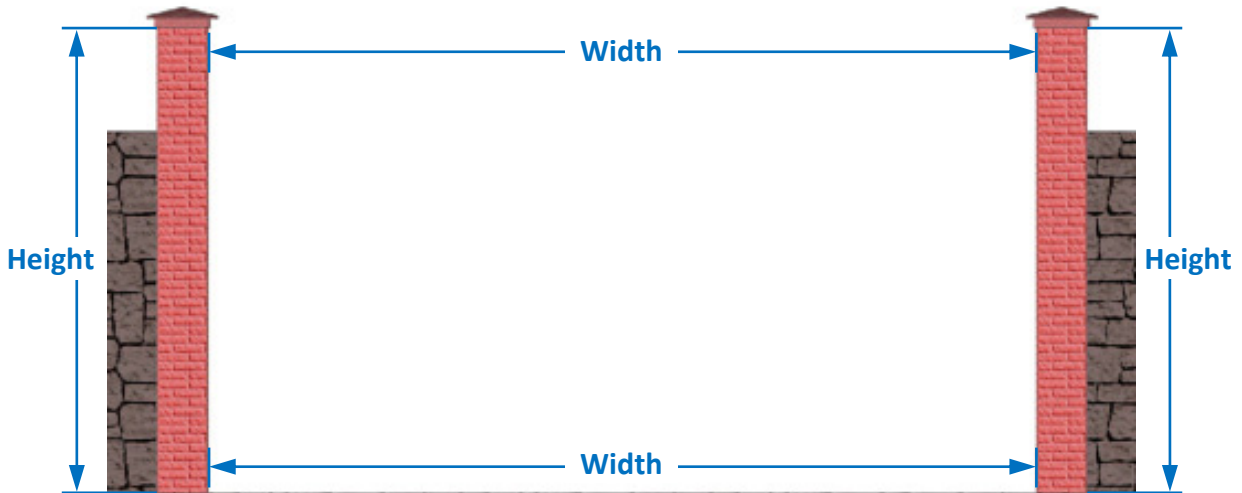

- Check the width between posts and the height of the posts under the cap.

# Check the 0, plumb level and post alignment

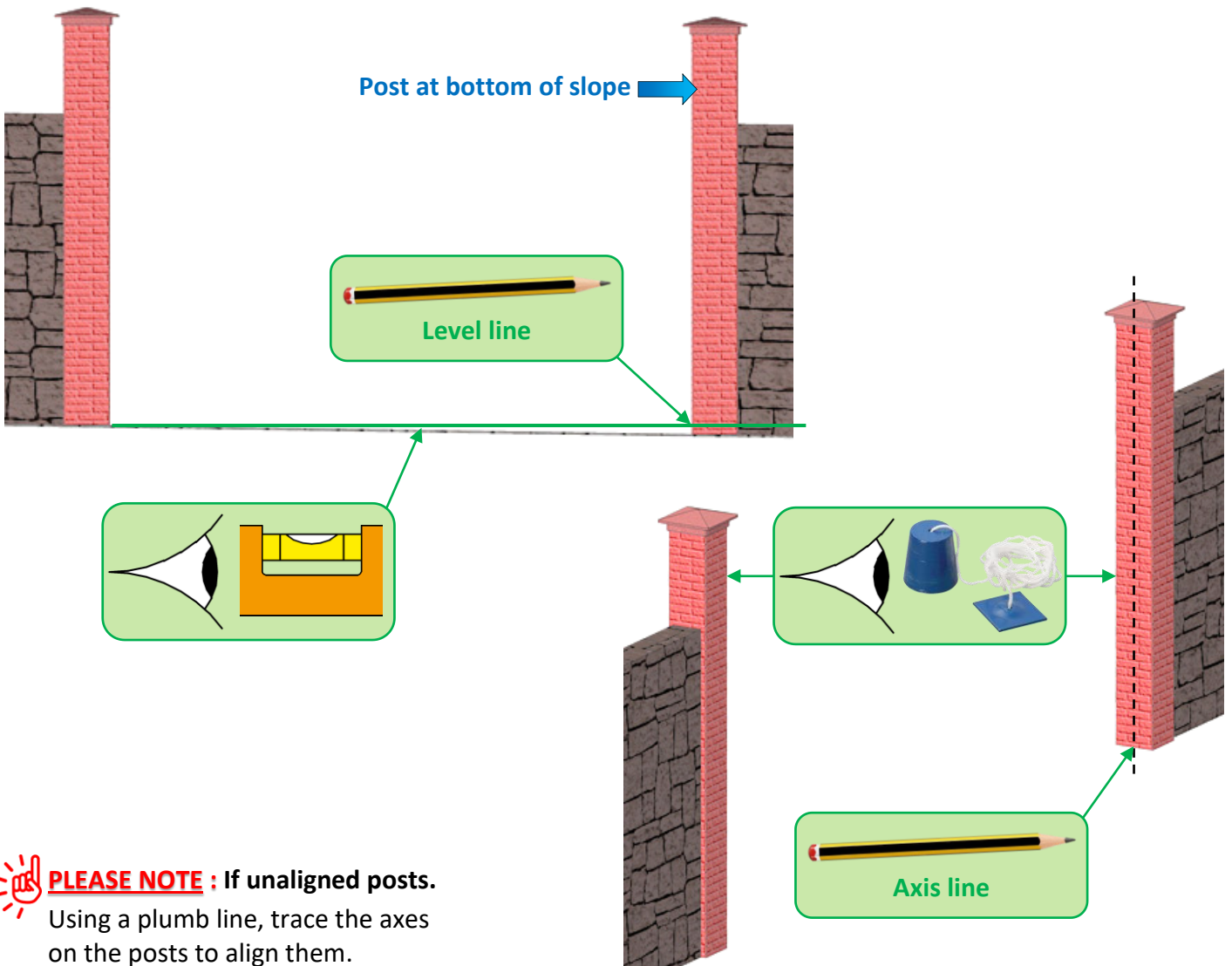

**PLEASE NOTE :** If unaligned posts.  
Using a plumb line, trace the axes on the posts to align them.

## Mark out the axis to fix the strips

### Inter-wall installation

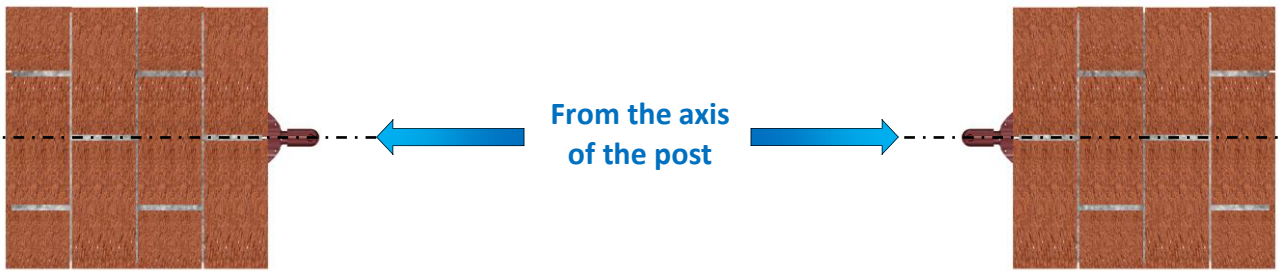

### Wall-mounted installation

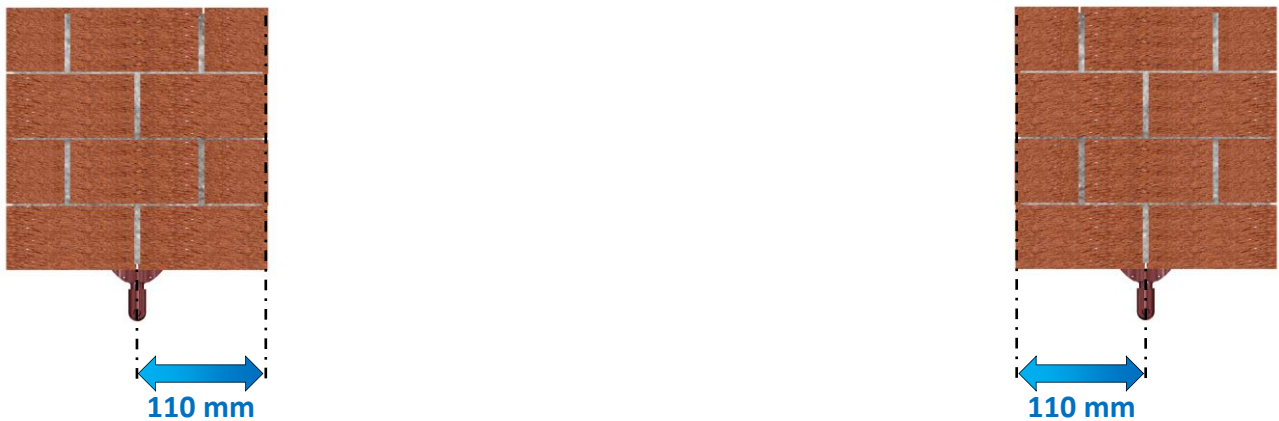

## Attach the 2 strips

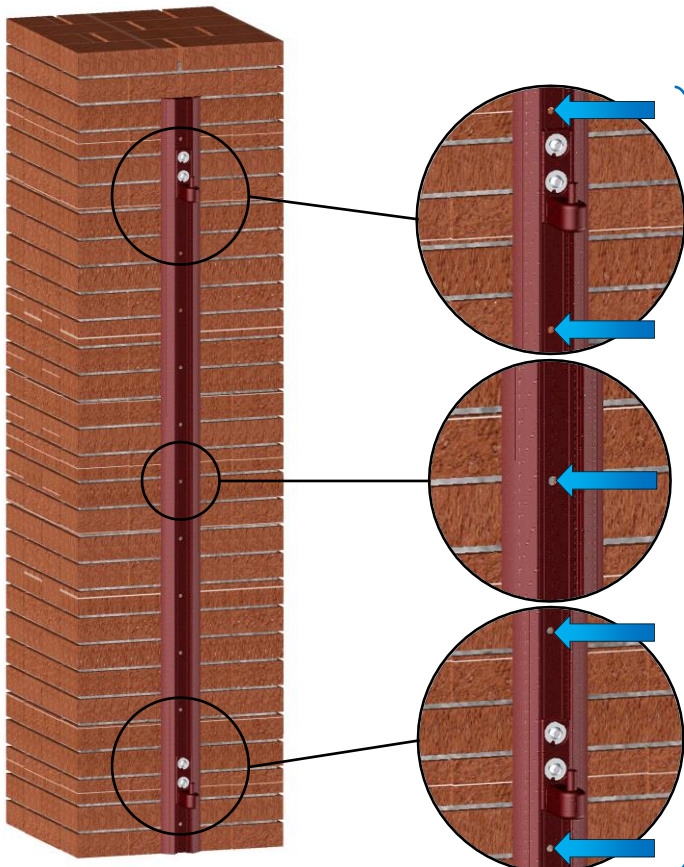

### **INFORMATION :**

If necessary, make additional holes on the strip.

**Drilling  $\varnothing 8$  mm, closest to hinges.**  
TH M8 screws recommended (not supplied).



### **PLEASE NOTE :**

Attach the hinges with the BHC M8x20 screws and washers (supplied).

# Check the level between the bottom hinges

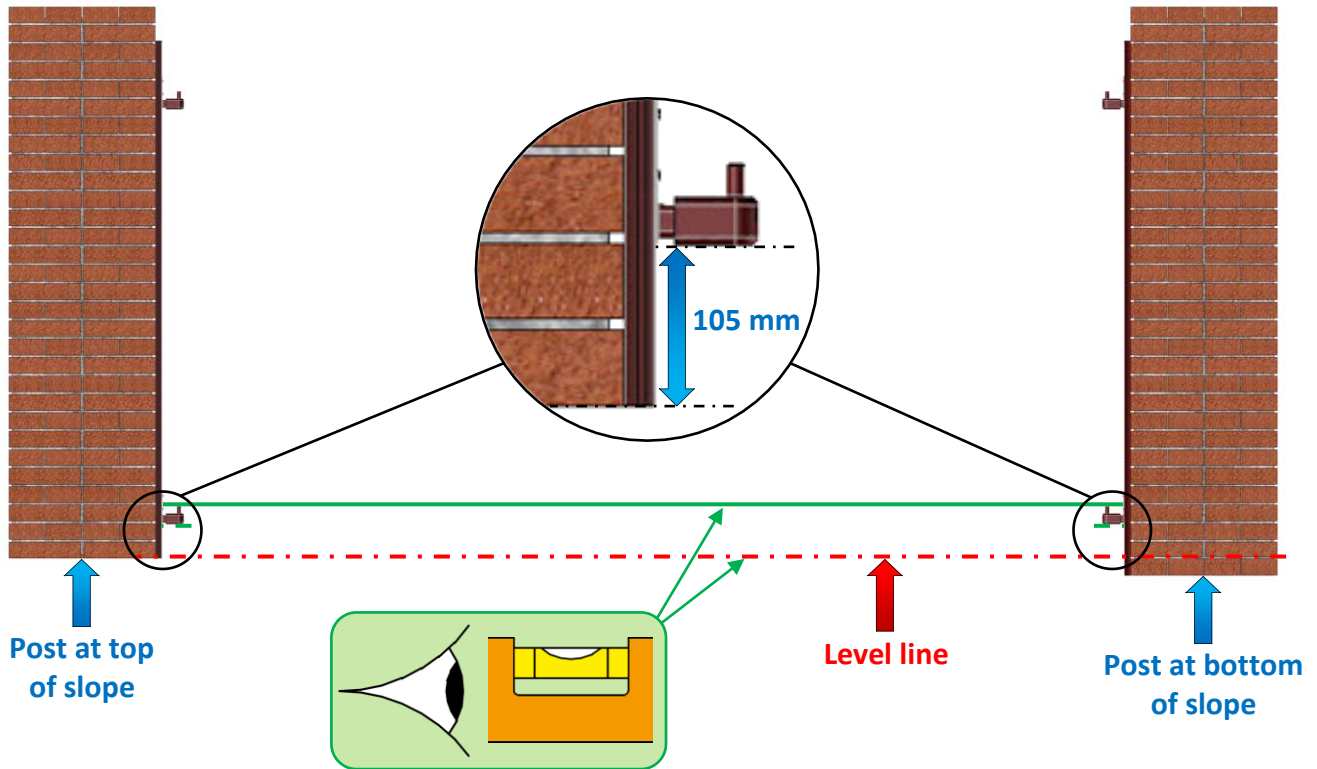

# Before installing the leaves

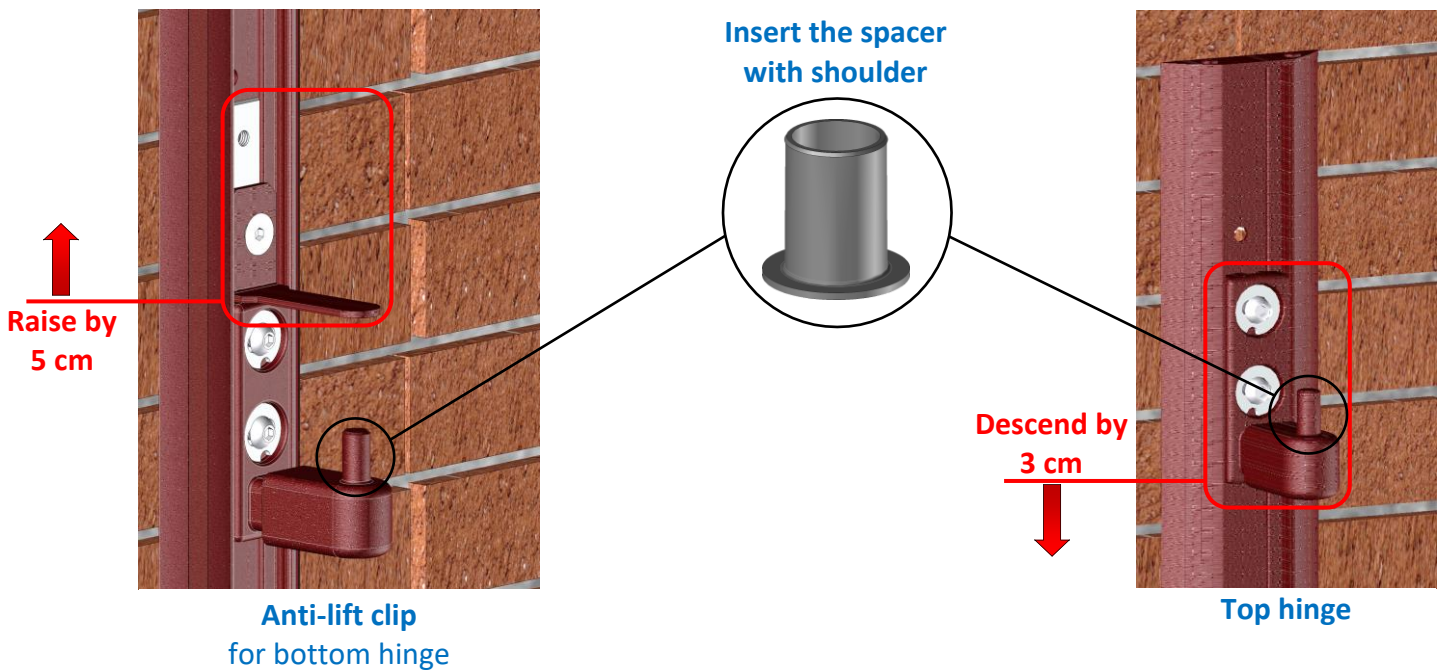

## Present and engage the leaves

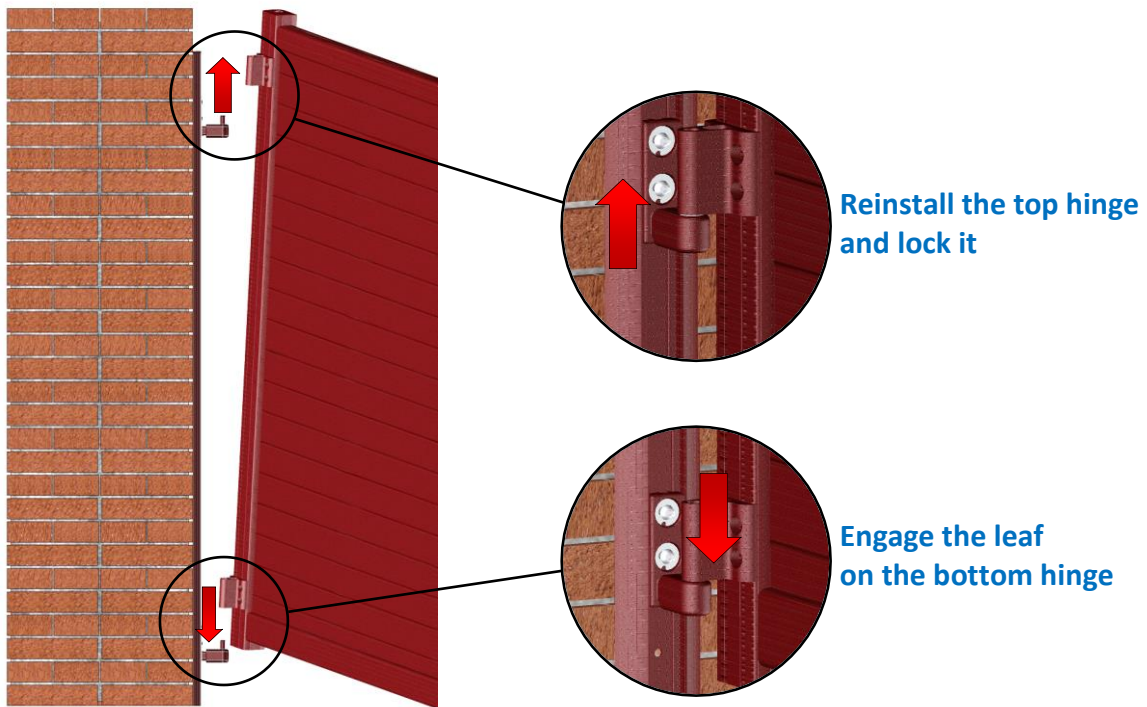

## Lock the leaves

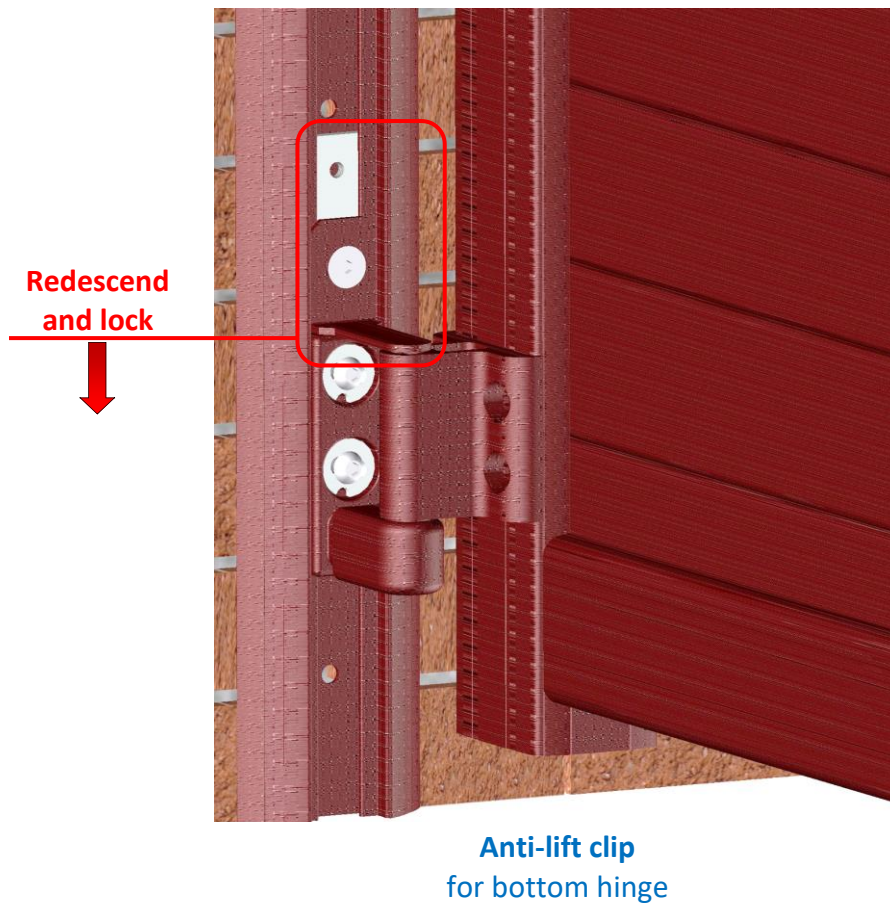

## Install the central stop



### **PLEASE NOTE :**

For more information, refer to the 2-leaf Gate or Wicket door installation manuals.